



# Card Safe™

The better memory card protector



## Card Safe™ Extreme Combi

From the outside, the Card Safe™ Extreme Combi looks exactly like its twin brother, the Card Safe™ Extreme. Inside, you can see the differences: The Extreme Combi has two compartments for bigger-sized memory cards and one compartment to safely store a battery or other smaller parts.

Because: What's the use of living through the best moments if the battery is empty and the backup battery has become wet?

The battery compartment is sized 49 x 32 x 10 mm and is suitable for different types of batteries.



### Features



2 Multi Card Compartments\*



Anti-Static Inner Material



Shock Resistant



Dustproof



Waterproof



Floats



Connector



Viewing Windows

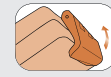

Ergonomic Lock

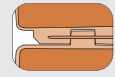

Stainless Steel Pin

\* plus additional compartment for a battery or other accessories (size: 49x32x10mm). If this part is to be used for memory cards it holds 2 Compact Flash.

### Size & Weight



Heavy weight:  
90 gramm

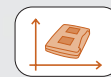

Outer measurements  
WHD: 99 x 24 x 77 mm

### Colours & Art.No.

Onyx

#3867

### Suitable for



CF  
(Type I)



CF  
(Type II)



Smart  
Media



MMC



SD



Memory  
Stick

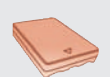

Accessory  
Stick